



COMMISSIONER, BRUHAT BANGALORE MAHANAGARA PALIKE

Narasimha Raja Square, Bangalore - 560 002.
Tel. : 080-22237455 / 22221286 Fax : 080-22223194
E-mail : commissioner@bmrponline.org

No: PSR (4)/PR/50/2020-2021

Date: 19-04-2020

ORDER

In exercise of powers conferred under Section 24 of the Disaster Management Act, 2005 to Commissioner, BBMP through Order No: RD158TNR 2020 dated 14.4.2020 of Government of Karnataka and in compliance of Circular No HFW: 109 ACS 2020 dated 17.4.2020, Containment Zones are to be identified in view of COVID-19 Positive case and aggregation of epidemiologically linked COVID-19 cases in a limited area to prevent the further spread of infection.

The following areas are hereby declared as Containment Zones to prevent the spread of infection in the community:-

CONTAINMENT ZONES

Sl. No	Zone	Ward No	Patient I.D	Area (A) / Apartment (AP) / Cluster (CL)	Activities done/ Ongoing				*Date of return of Containment Zone to Normalcy
					House to House Survey	IEC	SWM (Sanitation / Spraying / Fogging)	Contact Tracing	
1	2	3	4	5	6	7	8	9	10
1	South	177	P-57 P-58 P-129 P-132	A-1	✓	✓	✓	✓	01-05-2020
2	South	171	P-132	AP-01	✓	✓	✓	✓	01-05-2020
3	South	179	P-43 P-44 P-152	A-2	✓	✓	✓	✓	03-05-2020
4	South	134	P-189 P-190	A-3	✓	✓	✓	✓	06-05-2020
5	South	124	P-196	A-4	✓	✓	✓	✓	07-05-2020
6	South	166	P-197	A-5	✓	✓	✓	✓	07-05-2020
7	South	118	P-217	A-6	✓	✓	✓	✓	09-05-2020
8	South	118	P-349	A-7	✓	✓	✓	✓	10-05-2020
9	East	62	P-195	A-8	✓	✓	✓	✓	07-05-2020
10	East	78	P-208	A-9	✓	✓	✓	✓	08-05-2020
11	East	59	P-218	AP-02	✓	✓	✓	✓	09-05-2020



12	East	18	P-25	CL-01	✓	✓	✓	✓	09-05-2020
			P-55						
			P-61						
			P-68						
			P-59						
			P-92						
			P-215						
13	West	107	P-102	A-10	✓	✓	✓	✓	28-04-2020
14	West	139	P-252	CL-02	✓	✓	✓	✓	14-05-2020
			P-277						
			P-280						
			P-281						
			P-327						
15	West	135	P-167 TJ	CL-03	✓	✓	✓	✓	16-05-2020
			P-168 TJ						
			P-181						
			P-198						
			P-199						
			P-247						
			P-291						
			P-316						
			P-317						
			P-291						
			P-292						
			P-350						
			P-351						
			P-352						
			P-353						
P-354									
P-376									
P-377									
P-378									



16	R.R.Nagar	160	P-253	A-11	✓	✓	✓	✓	11-05-2020
17	Mahadevpura	54	P-93	A-12	✓	✓	✓	✓	27-04-2020
18	Mahadevpura	25	P-101	AP-03	✓	✓	✓	✓	28-04-2020
			P-131						
19	Bommanahalli	192	P-170Q	AP-04	✓	✓	✓	✓	11-05-2020

* Subject to the condition of non-reporting of new COVID case within last 28 days of the positive case of the containment zone and less than 10 contacts remaining in Home Quarantine in Containment zone.

- “A” is an Area around Independent House
- “AP” is Apartment
- “CL” is Area around Cluster of Cases

A-1 :	Mapped Area around No.142, Dollars Colony, J.P.Nagar. Bengaluru.
AP-1 :	Pyramid Classic Apartment, 1st A Cross 8th Main, Gurrappanapalya, Bengaluru
A-2 :	Mapped Area around No:420/96 43rd Cross 8th Block, Jayanagar
A-3 :	Mapped Area around No 25, 3rd Cross, Nehru Road, New Guddadahalli, Mysore Road, Bengaluru
A-4 :	Mapped Area around No 64, 4th Cross, Telecom Layout, Near Kingdom School, Vijayanagar, Bengaluru
A-5:	Mapped Area around 24th A Cross 7th Main Karesandra, Bengaluru
A-6 :	Mapped Area around No.8, 5th Cross, Doddamavalli, Bengaluru Urban, Karnataka.
A-7 :	Mapped Area around No.48, 2nd Cross, YM Shala, Vinobhanagar, JC Road Bengaluru - 2.
A-8:	Mapped Area around #15/2, 2nd cross, Marappa garden, Benson town post, B'lore-46.
A-09	Mapped Area in Nethaji Road, Opp Surya Kiran Apartment, Pulikeshinagar, Bengaluru.
AP-02:	Hutchisons Manor Apartment, No.26, Hutchinsons Road, Cooks town, Bengaluru.
CL-01 :	Mapped Area in Ward No.18, Radhakrishna Ward.
A-10 :	Mapped Area around House No:271, 4th Cross 3rd Main, Shivanagar, Bengaluru
CL-02 :	Tippu Nagar
CL-03:	Padarayanapura
A-11:	Mapped Area around No.15, 1st Main, 1st Cross, HV Halli, Shivanna Layout, R.R.Nagar, Bengaluru - 560 079
A-12	Mapped Area around No.33, 4th Cross, Mottappa Kempanna Layout, Anandapura, TC Palya, Near Mother Theresa School, Bengaluru
AP-03 :	C-Manthri Splendor Apartment, Geddalahalli, Bengaluru
AP-04 :	Vayusthuthi Vaibhava Apartment, 3rd Cross, Purandaradasa Main Road, Akshayanagara, Bengaluru - 560 068.

** Maps of Containment Zones is Annexed



MAHANAGARA PALIKE

“A” Containment Zone limits will be 100 Meters radius around the COVID-19 Positive Case premise.

“AP” Containment Zone limits will be the entire Apartment Block/Building.

“CL” Containment Zone limits will be as defined in the Map Annexed.

The following action shall be taken immediately in the aforementioned Containment Zone:-

Activities:

A. Crisis Management Team

- ✓ Incident Commander – Crisis Management Team: He will be responsible for overall management of the Containment Zone and Buffer Zone.
- ✓ Incident Command Centre would be the Ward Office of BBMP.
- ✓ Logistic Support to Incident Commander shall be provided by BBMP.
- ✓ Joint Commissioner, Zone shall ensure that all necessary support from engineering, solid waste management, health and revenue teams of BBMP is provided to the Incident Commander.

B. Special Health Needs:

- ✓ Health Authorities shall identify and list persons requiring special needs (Pregnancies, Cardiac Disease and other serious ailment) in Containment Zone with the help of Resident Welfare Association for the Building/ Area placed under Containment Zone.

C. Perimeter Control

- ✓ Police Authorities will have to cordon off all entrances and not entail any person coming out of Containment Zone for any purpose.
- ✓ There will be only one entry and exit for each Containment Zone. No Private Vehicle would be allowed inside or outside the Containment Zone.
- ✓ Police Authority to ensure that there is complete sealing of the Area.
- ✓ Police to undertake complete curfew management and allow essential services and medical emergencies. Police Authorities can use Drone and other technologies in Containment Zone for total lockdown.
- ✓ There shall be restriction on the movement of persons even inside the Containment Zone.

D. Surveillance and Preventive:-

- ✓ Health Authorities shall immediately start Surveillance and Preventive activities and establish Health Outpost with necessary field staff for health screening along with intensive Information, Education & Communication campaign.



MAHANAGARA PALIKE

- ✓ Contact Tracing & Tracking as per protocol and immediate shifting of High Risk Contacts to institutions and subjecting Low Risk Contacts to Home Quarantine is to be done. (Low Risk to be moved to Institutions based on the area in which they are residing like slums).
- ✓ Testing of Swab Samples of High & Low Risk Contacts.
- ✓ Health profiling of entire population to find Influenza like Symptoms and Severe Acute Respiratory Illness and subject them to necessary treatment.
- ✓ Shifting of Secondary Contacts (Low Risk Contacts) from Home to Institutional Quarantine (Hotels) in case of slums identified in CL- 2 & 3.

E. Solid Waste Management:

- ✓ Solid Waste Management Authorities to ensure daily Waste management that is inclusive of Bio-Medical Waste Management and ensure spraying of disinfectant in the Containment Zone.
- ✓ Power Sprayers, Drone Sprays and Jetting Machines etc. shall be deployed extensively in the Containment Zones for effective and sustained sanitization of the area.

F. Essentials: In view of restriction of movement of persons residing in the Containment Zone both inside as well as outside the Containment Zone, it is imperative to ensure that the essential commodities are made available at their door step.

- ✓ BBMP to ensure provision of drinking water in case of shortage by coordinating with BWSSB.
- ✓ To ensure house to house provisioning of essential supplies and services.
- ✓ Food Packets and Ration provisioning for the needy in the Zone.
- ✓ Provision of Ration by Fair Price Shops at door step of the card holder.
- ✓ Provision of daily necessities like Milk, Newspaper, Vegetables, Groceries, Bread Products, Meat etc. is to be planned in a manner which takes into account time of requirement of such commodities and if an area/ cluster is large it can be further subdivided for the purpose of supplying essentials.

G. Miscellaneous

- ✓ Zonal Joint Commissioner, BBMP shall ensure that food arrangements are made to all staff deployed in the Containment Zone.
- ✓ Zonal Joint Commissioner, BBMP shall ensure marking of outer limit of Containment Zone in Area and Cluster Containment Zone with White Paint / any conspicuous way so as to facilitate the Police in barricading for effective Perimeter Control.
- ✓ Safety of the staff deployed in the containment zone shall be ensured by making available triple layered masks, gloves and sanitizers.



- ✓ Personnel deployed in the Containment Zone other than Police Personnel shall be provided with a Jacket for easy identification of such persons in the Containment Zone.
- ✓ BBMP to enlist service providers like plumber, electrician, gas agency so as to facilitate any inconveniences.
- ✓ BBMP to ensure mass IEC activities like loud speaker announcement, distribution of pamphlets and posters , engagement of electronic, print and social media for creating awareness on social distancing, signs and symptoms of disease, inculcation of healthy habits, nutrition etc.

H. Buffer Zone Management:

Intensive Buffer Zone will be 1 km radius wherein house to house screening will be done by health authorities. Health authorities will conduct active surveillance and social distancing measures in the Buffer Zone.

Incident Commander of the Containment Zone will be responsible for management of the Buffer Zone as well.

Social Distancing measures in area around Containment Zone in the buffer zone must be strictly enforced by Police and no public function / gathering is to be allowed in the buffer zone and use of masks to be enforced.

Surveillance by Health Team to find Influenza Like Illness and Severe Acute Respiratory Illness and managing the same through Fever Clinic or Isolation depending on the case.

Incident Command System will be as follows:

Sl. No.	Zone	Incident Commander Name, Designation & Contact No.	Containment Zone – Ward Name	Supervisor Name and Designation	Contact No.
1	East	Dr Mahesh, KAS, GM(Admin & HR), BESCOM, Bengaluru 94484-92187	18 (CL-01)	Sri Ashok, EE (Hebbal)	90350-09919
			59 (AP-02)	Sri Srikanth, AE, Ward-59	98450-13283
			62 (A-08)	Sri Vasu, EE (Shivajinagar)	90660-84112
			78 (A-09)	Sri Ravi, AEE (Pulikeshinagar)	96208-28222
2	West	Mr.Abhijin.B,KAS HQA, Office of the Commissioner for Charitable Endowment Department 99860-35230	139 (CL-02)	Sri Umesh, AEE (Chamarajpet)	98866-38403
				Sri Venkatesh, JE, Ward-139	99724-71115
			135 (CL-03)	Sri Thanvir Ahmed, EE (Chamarajpet)	94806-83855
			107 (A-10)	Smt Amrutha Sai, AEE (Sri Ramamandir)	96323-47753



Continuation Sheet.....

MAHANAGARA PALIKE

3	South	Mr. Veerabhadra Hanchinal, KAS,Special Officer, Kumara Krupa Guest House, Bengaluru 94480-36760	177 (A-01)	Sri Ramu, AEE (Jayanagar)	86604-75600
			134 (A-03)	Sri Ravi Varma, AEE (Vijayanagar)	99451-93601
			124 (A-04)	Sri Shivanna, AE, Ward-124	98861-65517
			179 (A-02)	Sri Manjunatha Reddy, EE (Jayanagar)	94806-84064
			166 (A-05)	Sri Yathish, AEE (Yediyur)	83102-81602
			171 (AP-01)	Sri Mahaboob Khan, AE, Ward-171	81479-29579
			118 (A-06)	Sri. Prassana Kumar, AEE, (Kempegowda Nagar)	98444-16237
			118 (A-07)	Sri Sathya, AE, Ward-118	99801-40025
04	Mahadevapura	Mr. S. Nagaraj, AS, GM, K.S.T.D.C 99864-75273	54 (A-12)	Sri Mohammed Shaik, AE, Ward-54	90088-00198
			25 (AP-03)	Sri Ramesh, AE Ward -25	97398-38297
05	R.R Nagar	Mr. Sangappa, Director, ST Welfare Department 97319-30970	160 (A-11)	Sri N. Basavaraj , AEE (R.R.Nagar)	94806-85630
06	Bommanahalli	Mr.Ballapa Handigud, Special Land Acquisition Officer, KIADB (BMRCL), Bengaluru 96201-02106	192 (AP-04)	Sri Vanaraju, AE, Ward -192	70226-04705

Substantial interventions and limitations in the aforementioned Containment Zone have already been put in place from the date of detection of COVID-19 Positive case in the area.

All the restrictions mentioned above shall come into effect from midnight of 20th April, 2020.

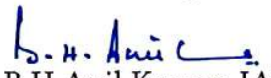
B.H. Anil Kumar, IAS 19/4/2020

Commissioner

Bruhat Bengaluru Mahanagara Palike

SKETCH SHOWING THE CORONA INFECTED PERSON HOUSE
IN WARD NO- 177, J.P. NAGARA.

A LIST

P- 57, 58, 129, 132

3.4.20

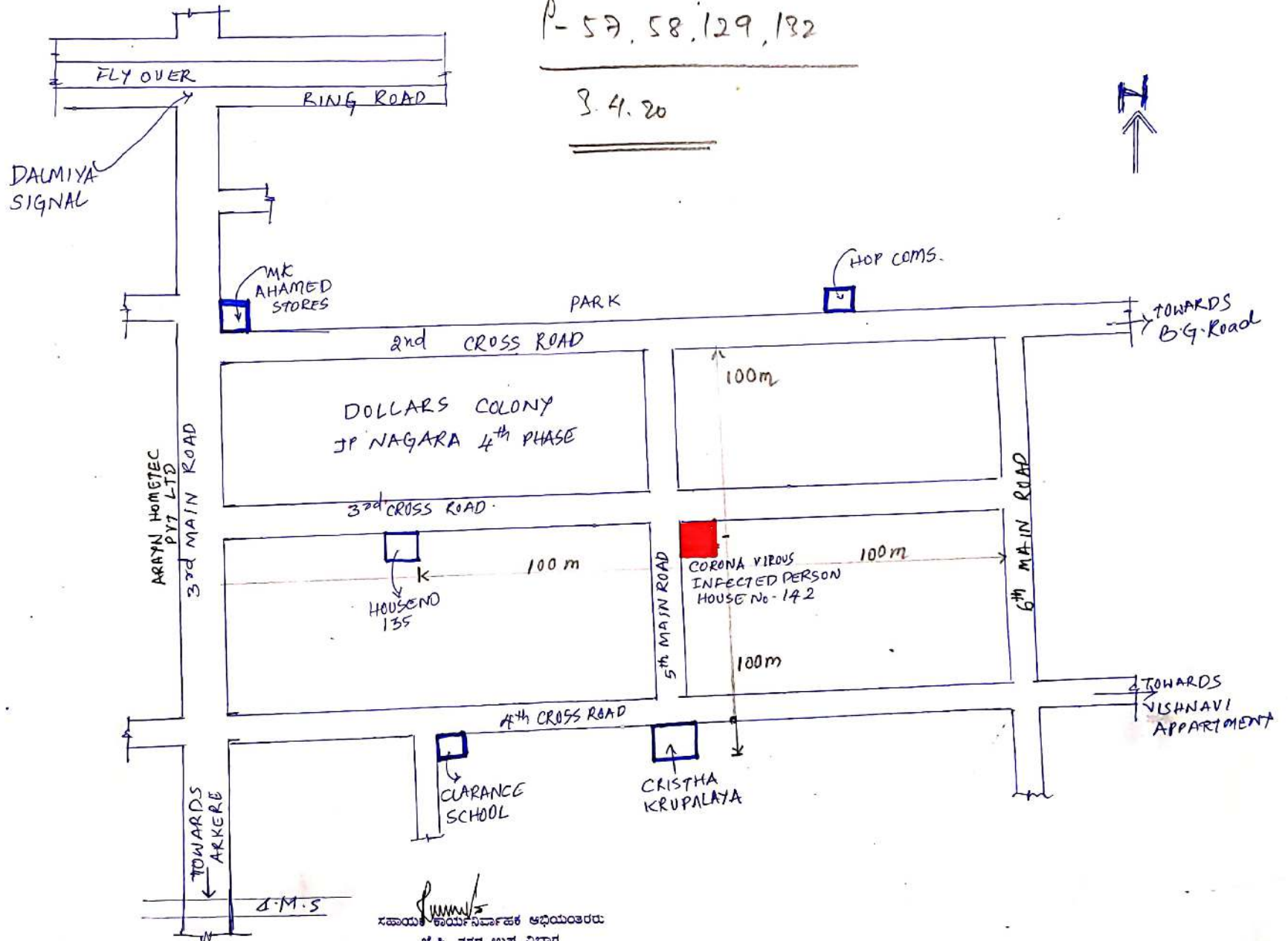

ಕಾರ್ಯನಿರ್ವಹಣಾಧಿಕಾರಿ
ಜಿ.ಪಿ. ನಗರ ಉಪ ವಿಭಾಗ
ಜಿ.ಪಿ. ನಗರ ಮಹಾನಗರ ಪಾಲಿಕೆ

KEY PLAN SHOWING THE RESIDENCE OF +VE COVID-19 CASE AT

GURUPANDALIYA WARD NO: 171.

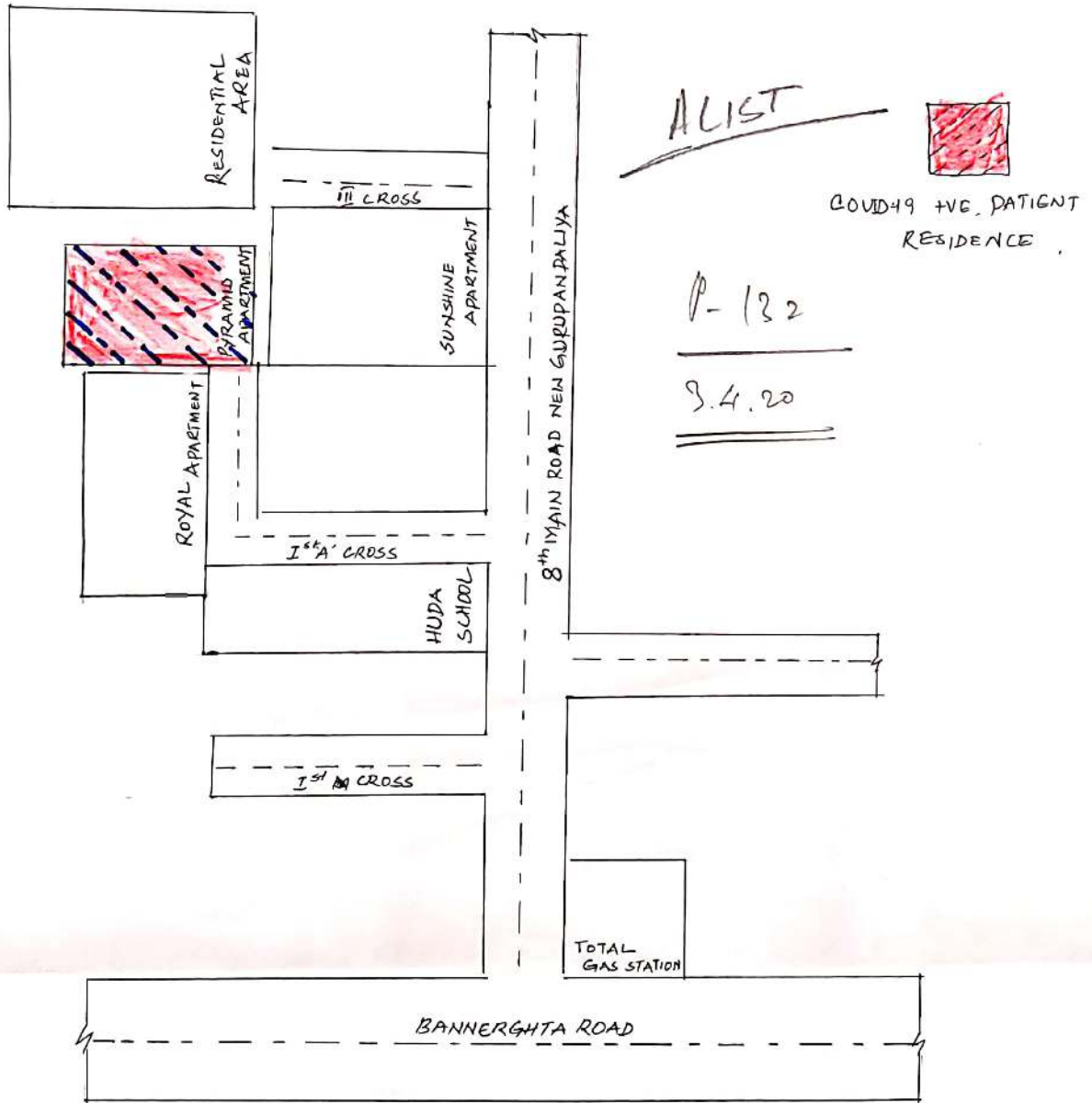

Rela
Ae-171

SKETCH SHOWING THE CORONA INFECTED PERSON HOUSE
 IN WARD NO-179, SHAKAMBARI NAGARA.

A LIST

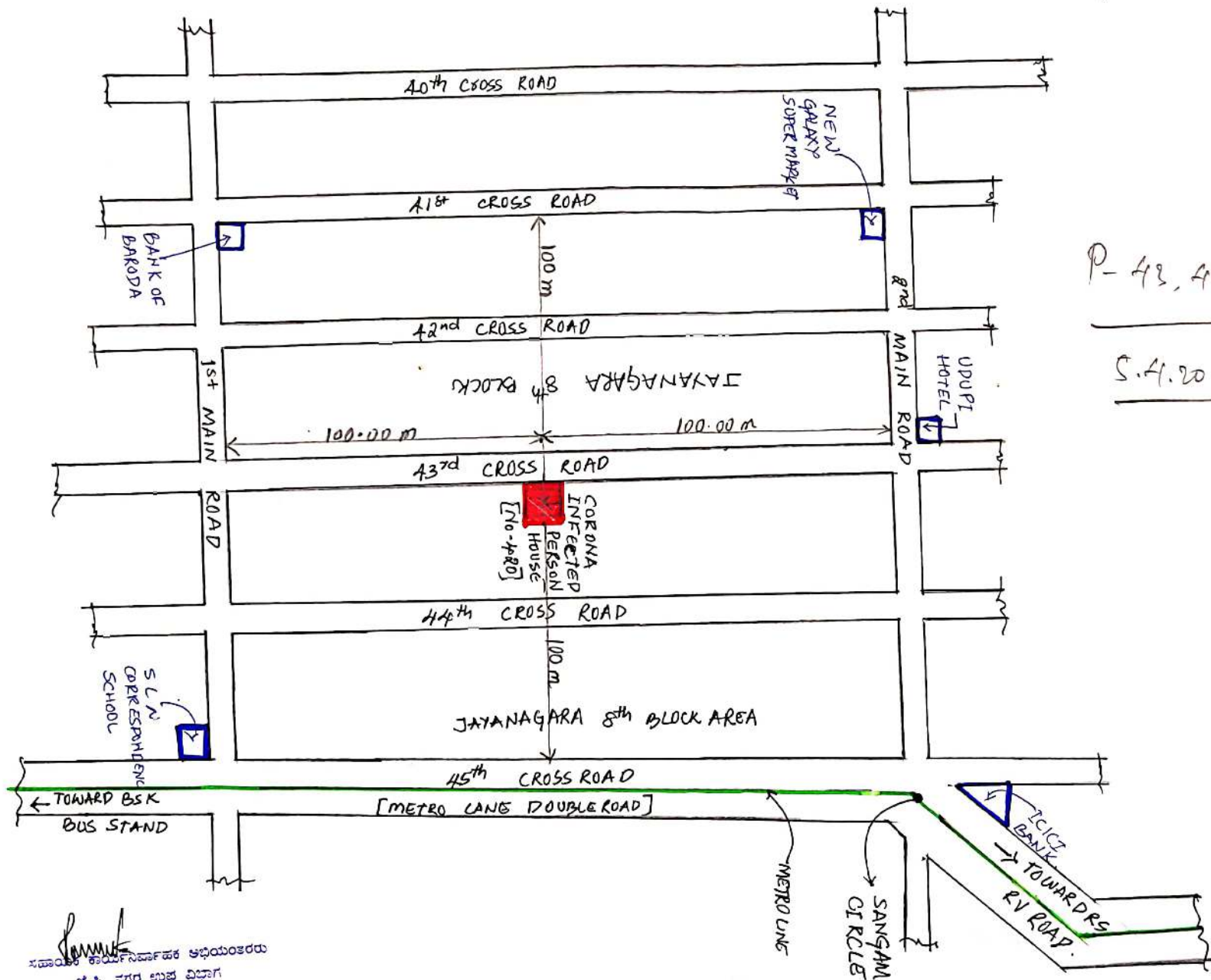

P-43, 44, 152

S.4.20

ಸಹಾಯಕ ಕಾರ್ಯನಿರ್ವಹಣಾ ಅಧಿಯಾತಕರು
 ಪಿ.ಪಿ. ನಗರ ಉಪ ವಿಭಾಗ
 ಶಾಂತಿನಗರ, ಬೆಂಗಳೂರು ನಗರ

ಬೃಹತ್ ಚಂಚಲತೆ ಮಹಾನಗರ ವಾಲ್ಡ್ **A LIST** 

ಬಾಪುಜಿನಗರ, ವಾಲ್ಡ್-134

Extract plan of W-134
Hosaguddadahalli.

Patient House Address

Babu's House,
3rd Cross
Nehru Road
HOSAGUDDADAHALLI
Bapujinagar,
ward-134
Bengalore.

P-189,190

8.4.20

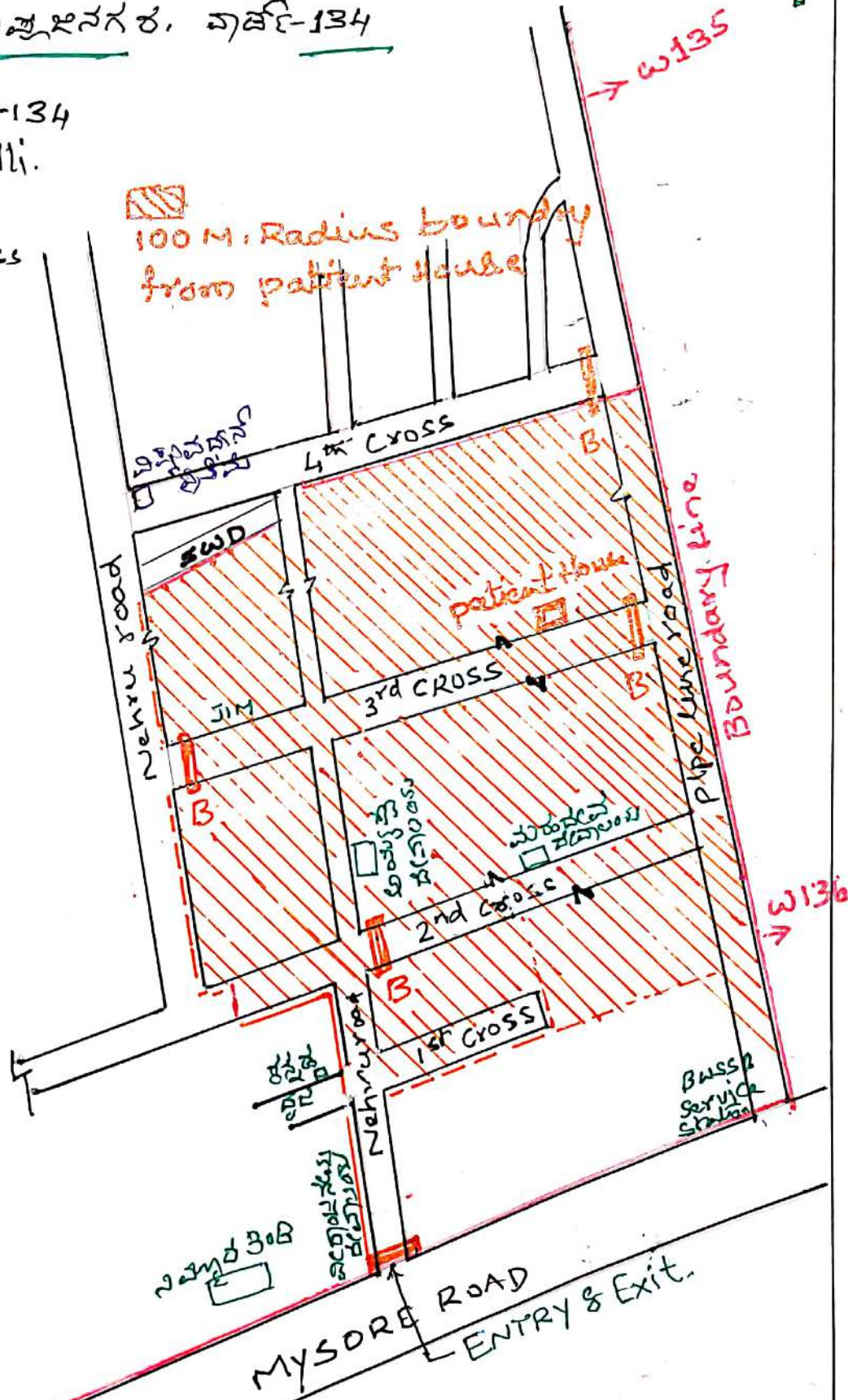

Bhuvan
7 AS.
WARD NO 134

20/04/2020
ಸಹಾಯಕ ಕಾರ್ಯನಿರ್ವಾಹಕ ಇಂಜಿನಿಯರ್
ವಿಜಯನಗರ ಉಪ ವಿಭಾಗ
ಬಿ.ಬಿ.ಎಂ.ಪಿ.

ಬೃಹತ್ ಬೆಂಗಳೂರು ಮಹಾನಗರ ಪಾಲಿಕೆ.
ವಾರ್ಡ್. 124.- ಹೊಸಹಳ್ಳಿ.

A LIST

P-196

9.4.20

Dr. B. R. Ambedkar layout.

- ① Perimeter Control
- ② Essentials
- ③ Sanitation Daily
- ④ H2H Survey completed

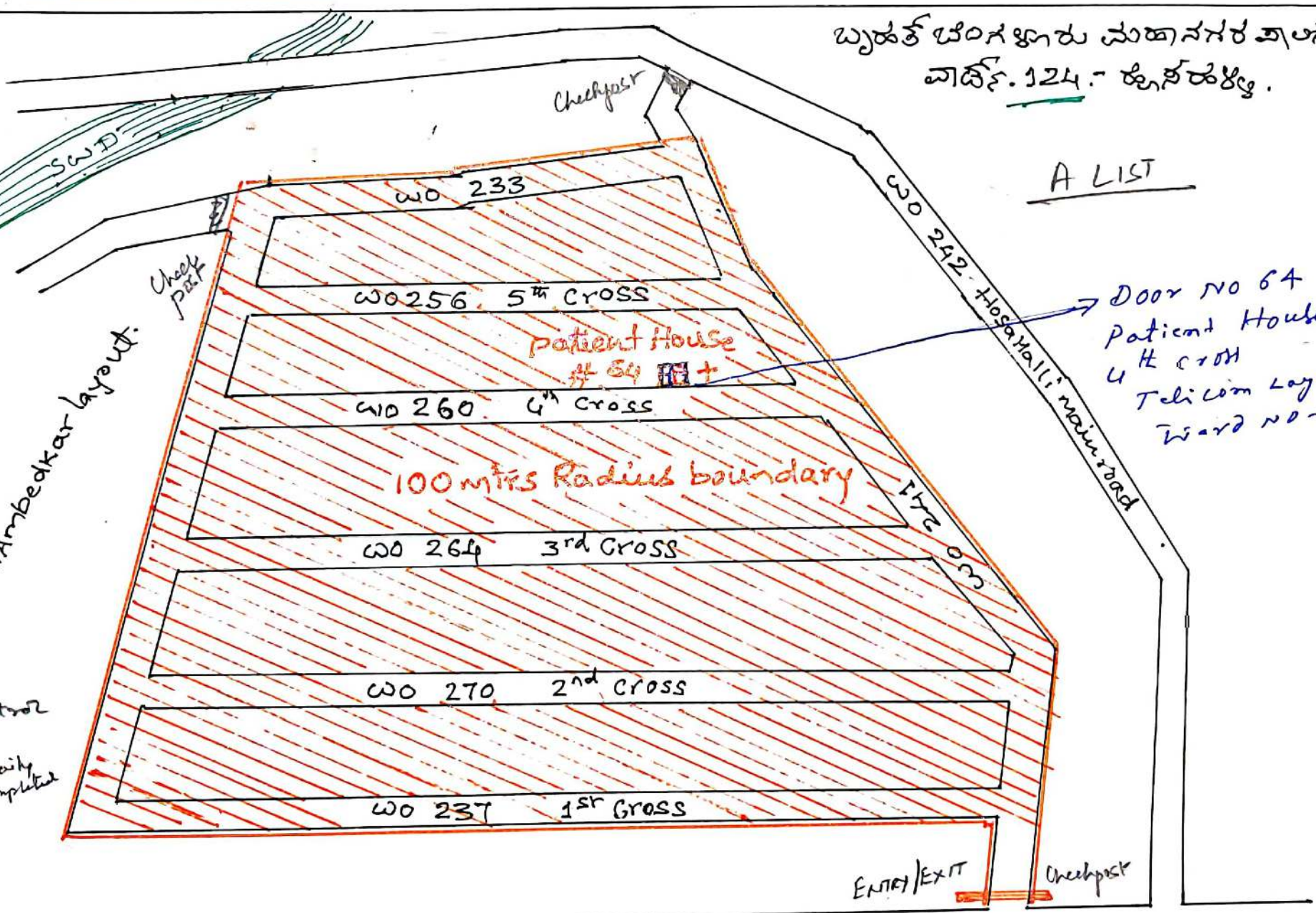

Door NO 64
Patient House
4th cross
Telicom Layout
Ward NO-124.

Padarayanapura main road.

B. R. Ambedkar
ASSISTANT ENGINEER
Ward No.124, (Hosahalli)
Wijayanagar Sub Division
BBMP, Bangalore.

B. R. Ambedkar 18/04/2020
ಸಹಾಯಕ ಕಾರ್ಯನಿರ್ವಾಹಕ ಇಂಜಿನಿಯರ್
ಬಿಜಯನಗರ ಉಪ ವಿಭಾಗ
ಬಿ.ಬಿ.ಎಂ.ಪಿ.

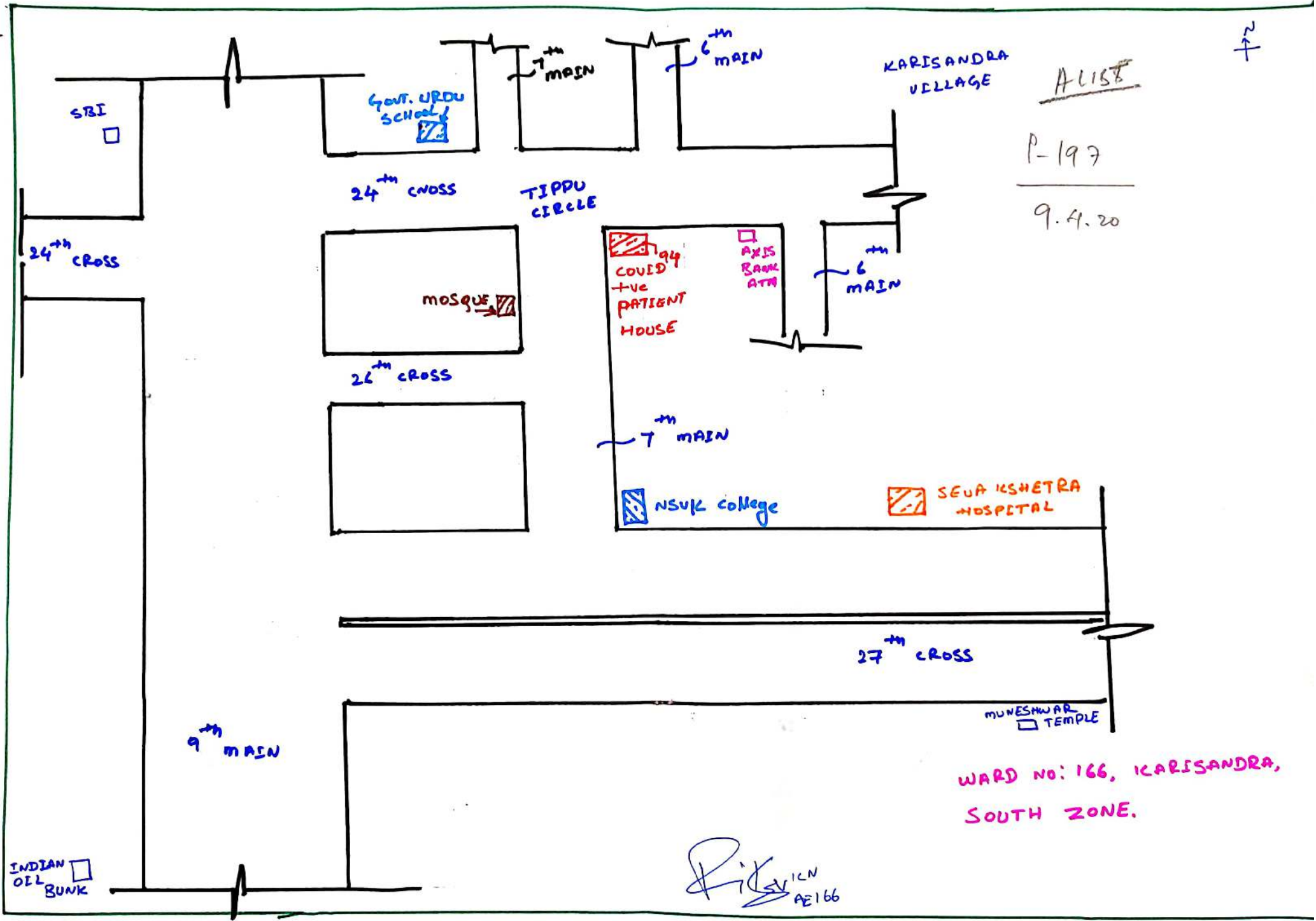

ALIST
 P-197
 9.4.20

WARD NO: 166, KARISANDRA,
 SOUTH ZONE.

Pit
 SVICN
 AE166

VINODHANAGAR - CONTAINMENT AREA

P 217
P 349
ALIST

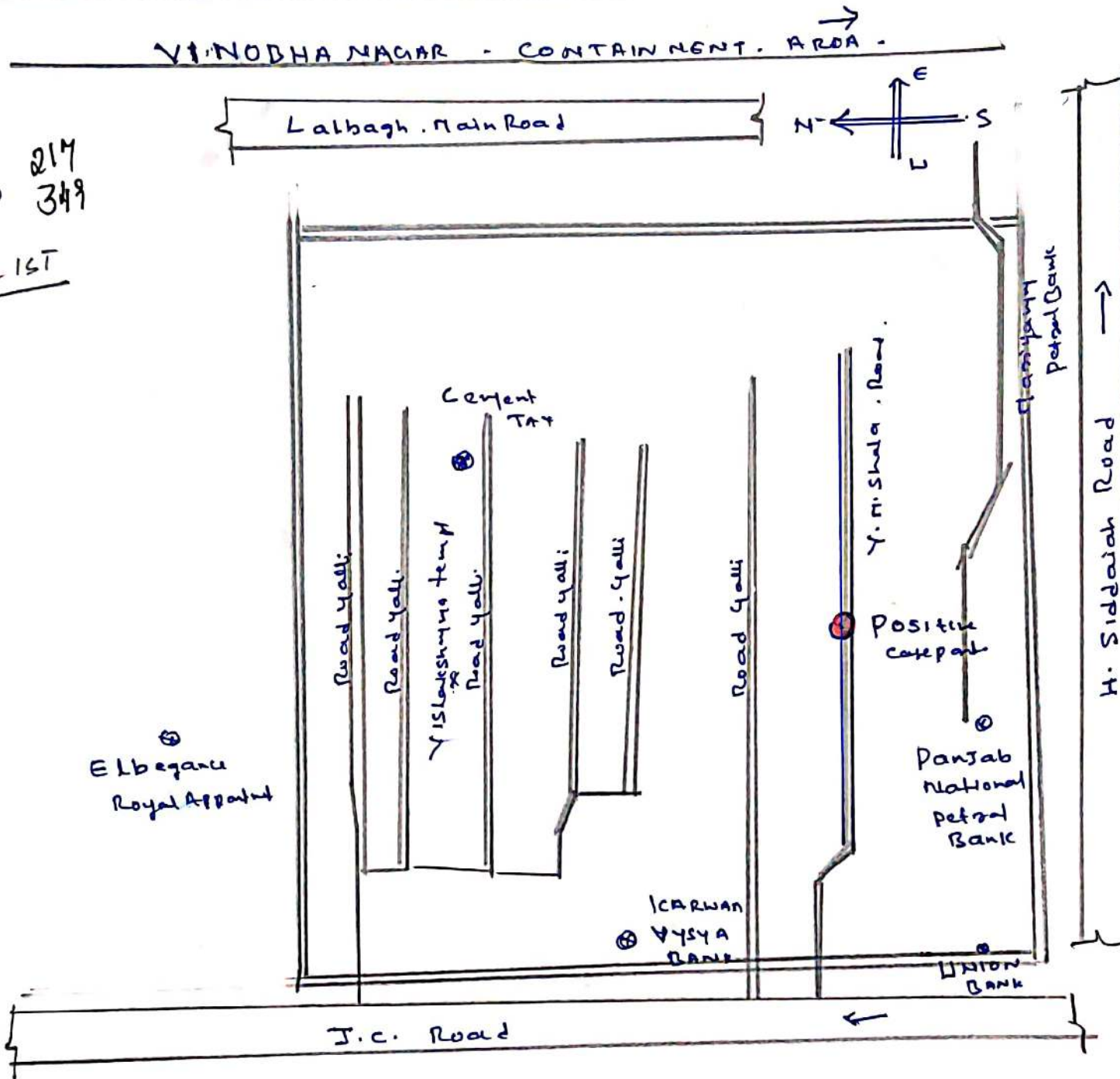

Elbegamu
Royal Apartment

Cement
TAX

Road Yalli

Road Yalli

Y. N. Shula Road

Road Yalli

Road Yalli

Road Yalli

Road Yalli

Y. N. Shula Road

Positive
Checkpoint

Panjab
National
Petrol
Bank

ICARWAN
VYSYA
BANK

UNION
BANK

J.C. Road

Changanthi
Petrol Bank

H. Siddaijah Road

- . Entry EXIT
- . Barricaded
- ⊙ . Positive Check

cu. k. sh. c.

N. K. SATHYA

Asst. Engineer

WARD - 118

Kemp Chowda Subdivisi.

PROPERTY - P-38

#45 VINODHAN

LALBHAGH. ROAD. Doddanavalli. CONTAINMENT AREA

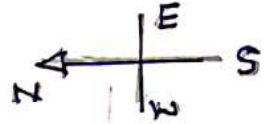
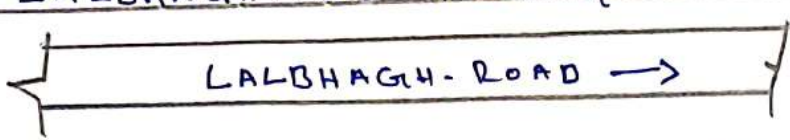

11/4

REFERRAL HOSPITAL

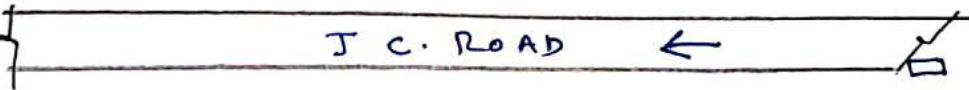
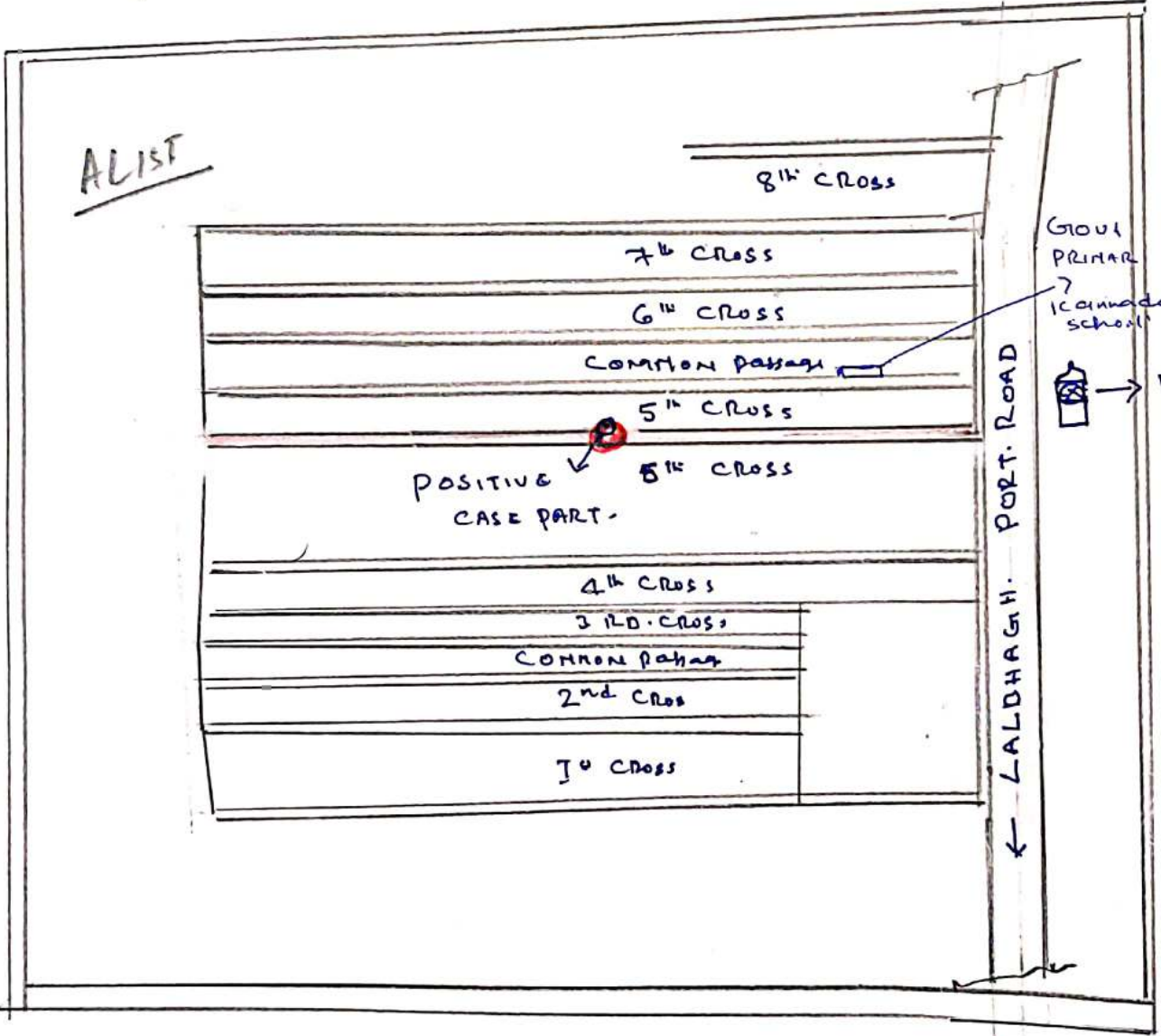

- . ENTRY EXIT
- . BARRICATED
- . POSITIVE CASE PROPERTY
- . MOSQUE

C. K. S. S.
 N. K. SATHYA
 Asst. Engineer
 WARD-118
 Kannegowda subd.

PROPERTY - # 811 511
 Cross. Lalbhagh
 Road
 Doddanavalli

DECEASED COVID-19 CASE in W-62, Ramaswamy Palaya. B.B.M.P. East Zone.

P-195

9.4.20

ALIST

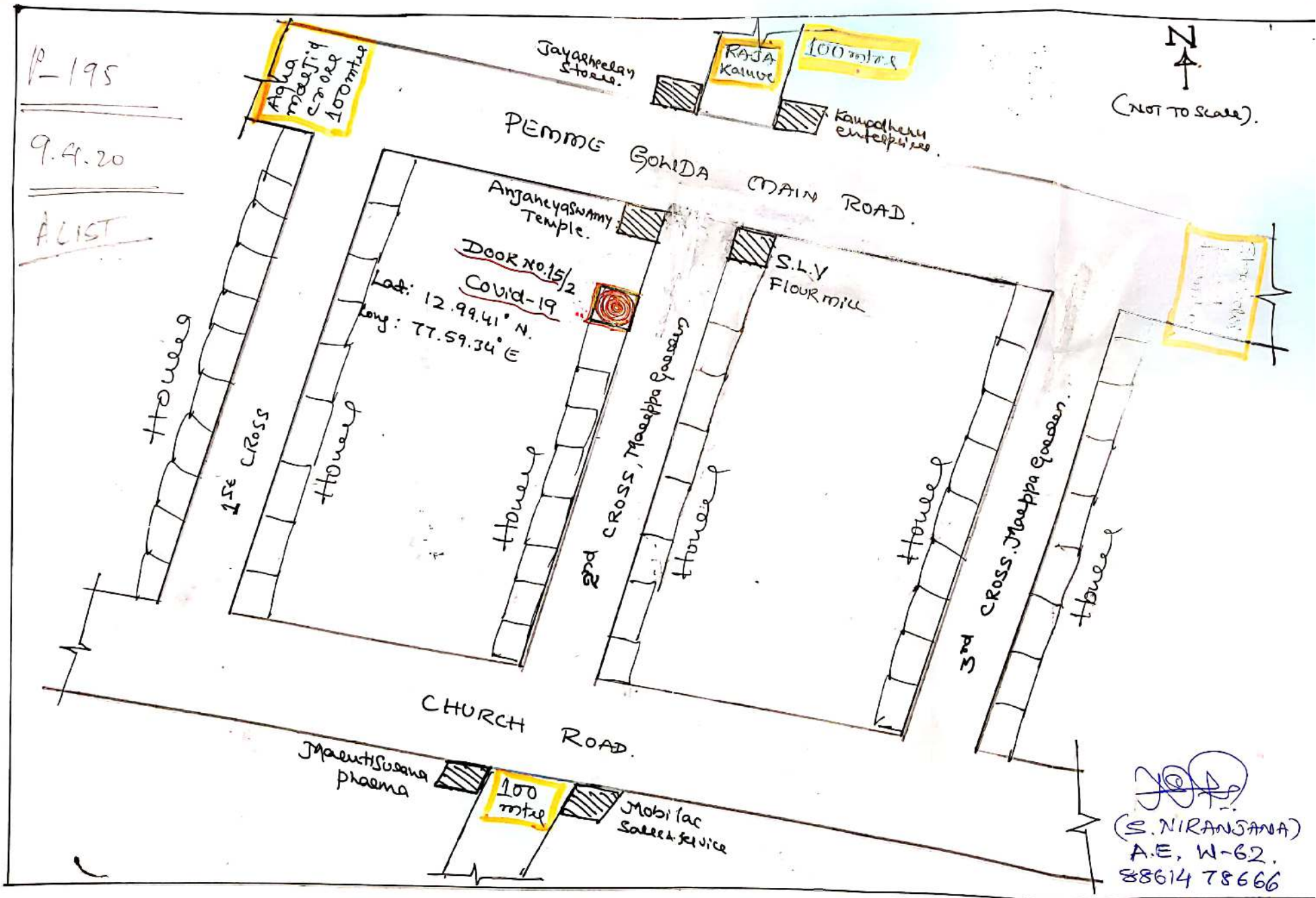
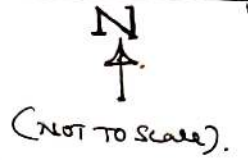

WARD 78 - PULKESHINAGAR

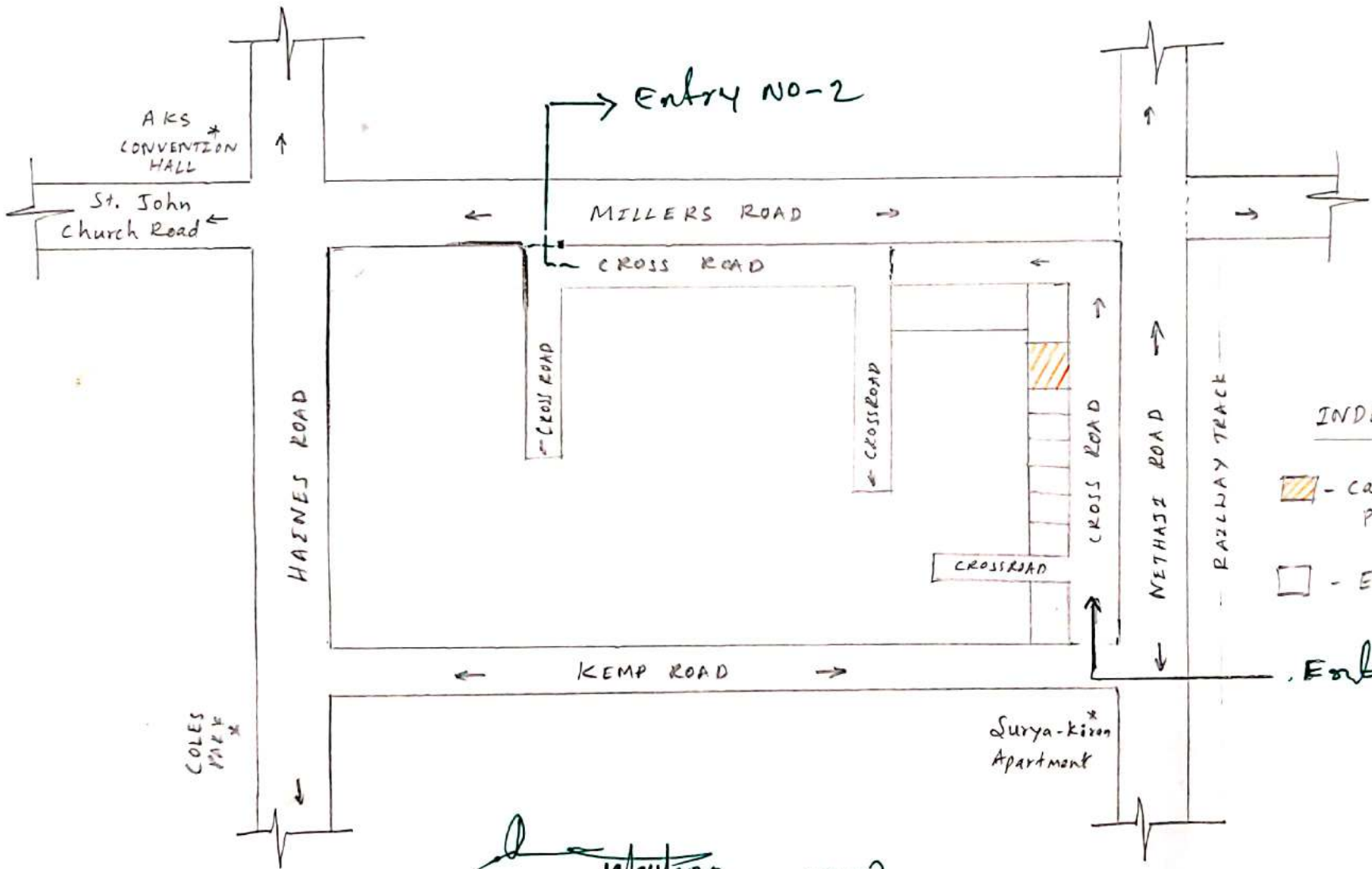

INDEX

 - Case Number P-208

 - Entry & Exit

Entry NO-1

Signature
AEE (PN)

WARD NO 59, MARUTHI SEVA NAGAR.

APARTMENT NAME : #26, HUTCHINS MANOR,

P218



DEVIS ROAD

PID NO: 86-2-26
NO. OF DWELLING
UNITS : 07 NUMBERS

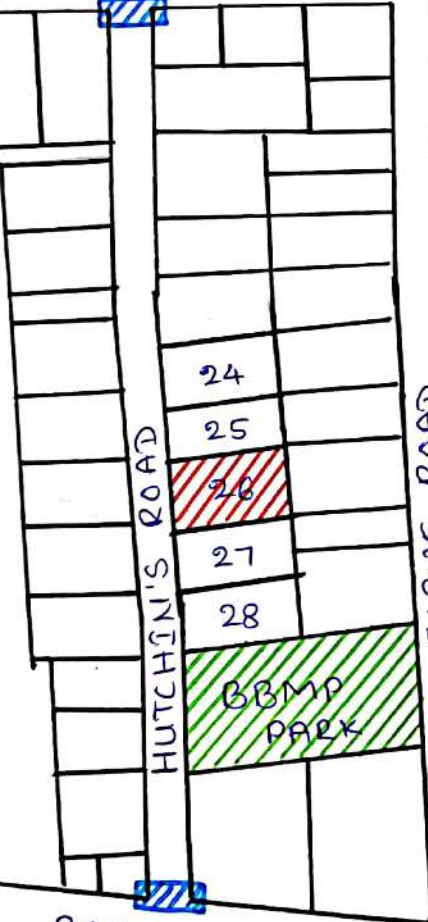



CLINE ROAD

LOYD ROAD

LAZER ROAD

INDEX

-  CASE NUMBER 218
-  ENTRY & EXIT
-  BBMP PARK
- POSITIVE CASE PART
- #26, HUTCHIN'S ROAD
- M.S. Nagar, Ward 59

Sri. [Signature] W/S9.

[Signature] AEE (M.S.N)

[Signature] AEO (M.S.N)

Ward No - 18 , Radhakrishna devastana .







B.B.M.P. R.O. PLANT

Geddalahalli 1st main →

Geddalahalli

Annayappa Layout.

INDEX

-  Case number P-25, P-55 & P-68
-  Case number P-215, P-59 & P-92 .
-  Entrance & exist.
-  B.B.M.P. R.O. Plant

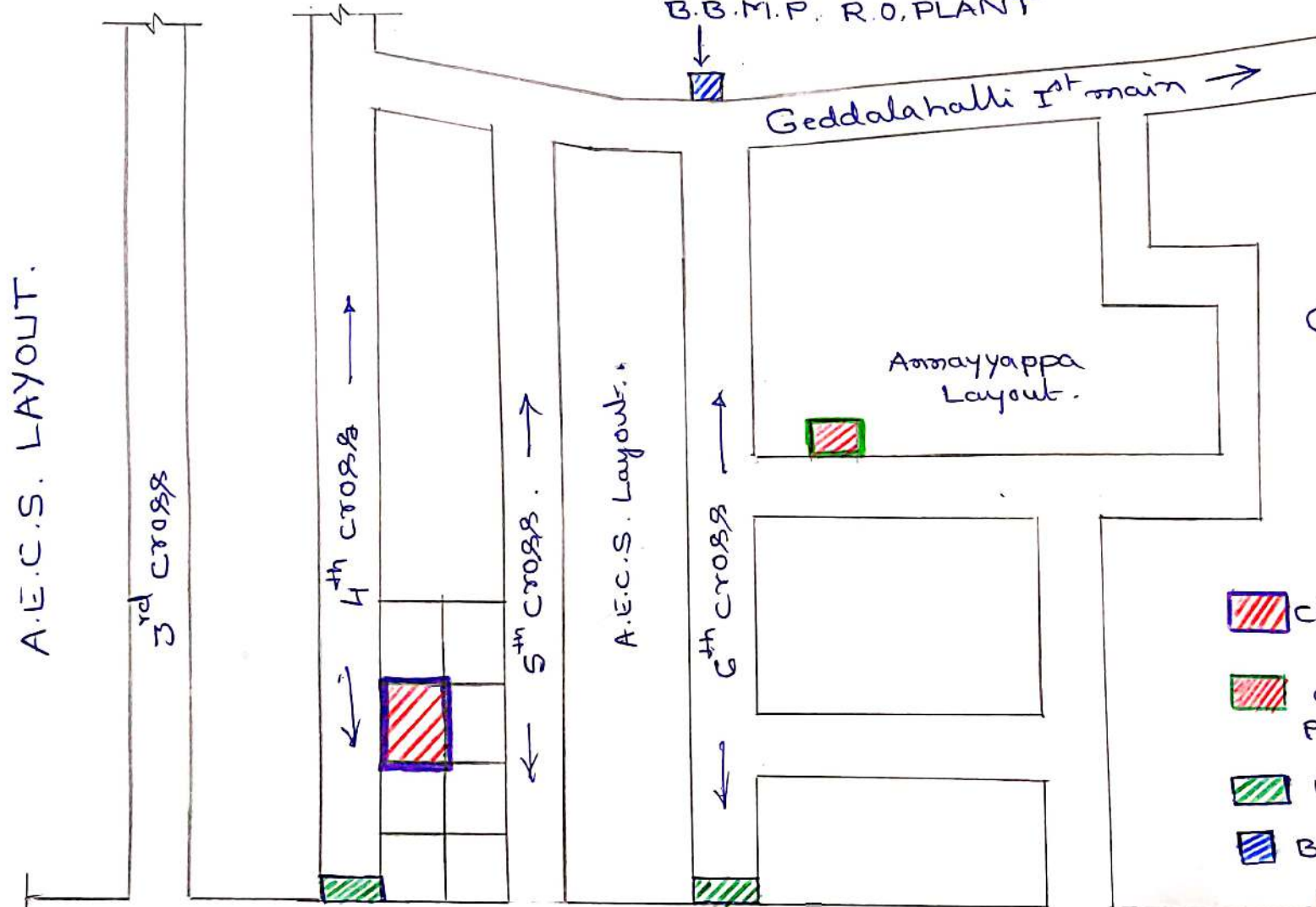

Towards
M.S. Ramaiah
Hospital

80 Ft Road

Towards
Sanjay nagar .

[Signature]
AS
Ward - 18.



[Signature]
ASB

[Signature]
ARO

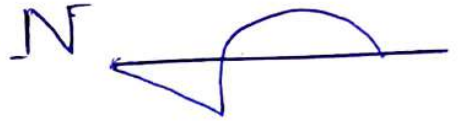
Ward - 18, Radhakrishnadevastana.



Index

-  Aanganeya temple
-  case number P-61
-  Entry & exist.

Sanjay nagar main road

← Towards Geddalahalli Bus stop

→ 1st main Geddalahalli

Geddalahalli Gramathana

1st cross Bante colony

2nd cross Bante colony

3rd cross

4th cross

Bante colony road

AS
Ward - 18.

ASB

ARO

Sketch showing the corona infected person house in ward No-107, Shivnagra

P-102
21.3.20

ALIST

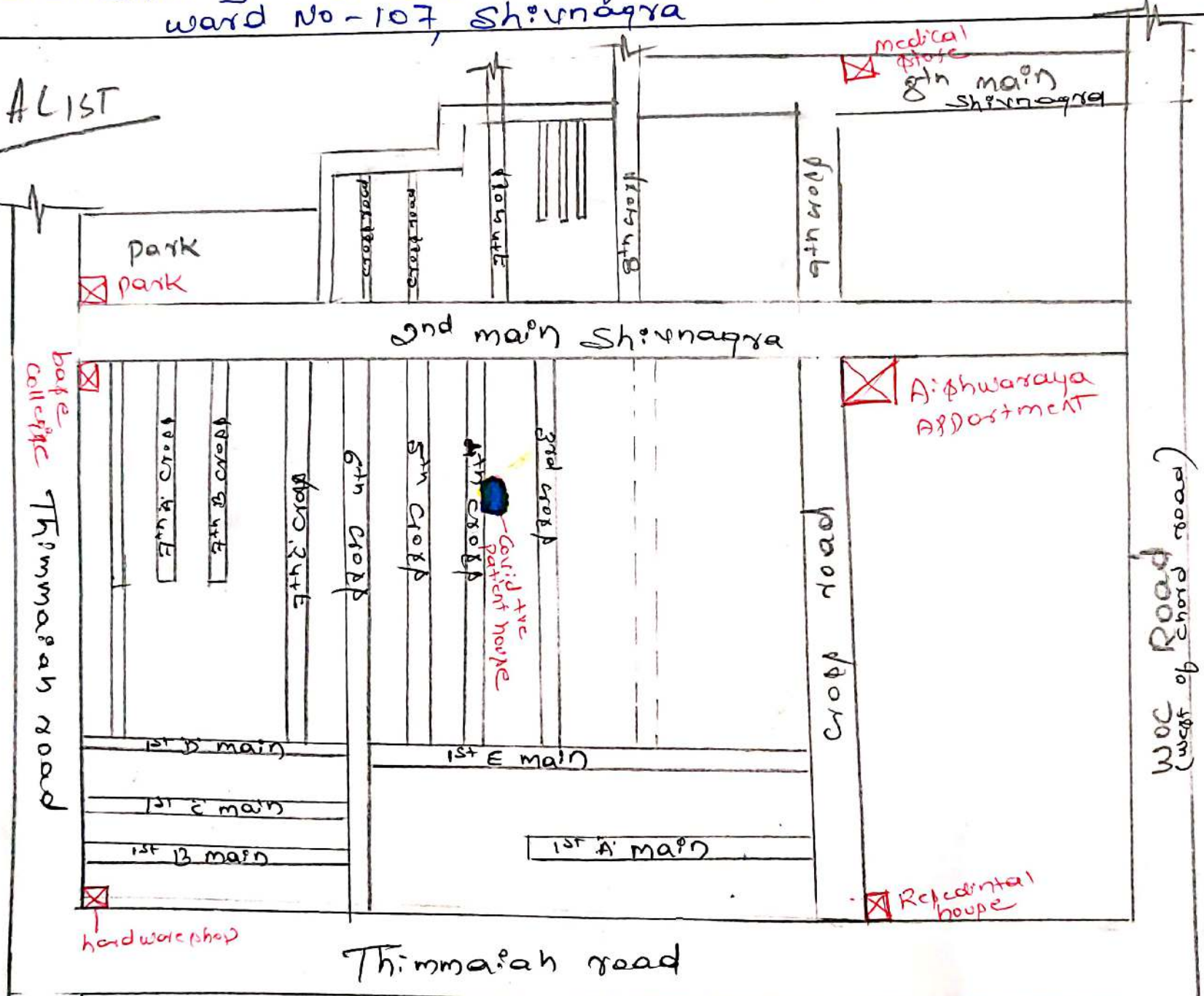

[Signature]
21.3.20

COVID +ve Patient House

AN

WARD - 139 K.R. MARKET VINAYAY THEATRE
TIPPUNAGAR CONTAINMENT AREA

A LIST



P 252
 277
 280
 281
 327

BOUNDARIES

- N:- ① MYSOREROAD TO PENSION MAHAL

- E:- ② PENSIONMAHAL BORDER TO 1ST MAIN CHAMARAJPET

- S:- ③ 1ST MAIN CHAMARAJPET TO 1ST CROSS CHAMPAS PET

- N:- ④ 1ST CROSS CHAMARAJPET TO ANJENAYA TEMPLE COMPOUND

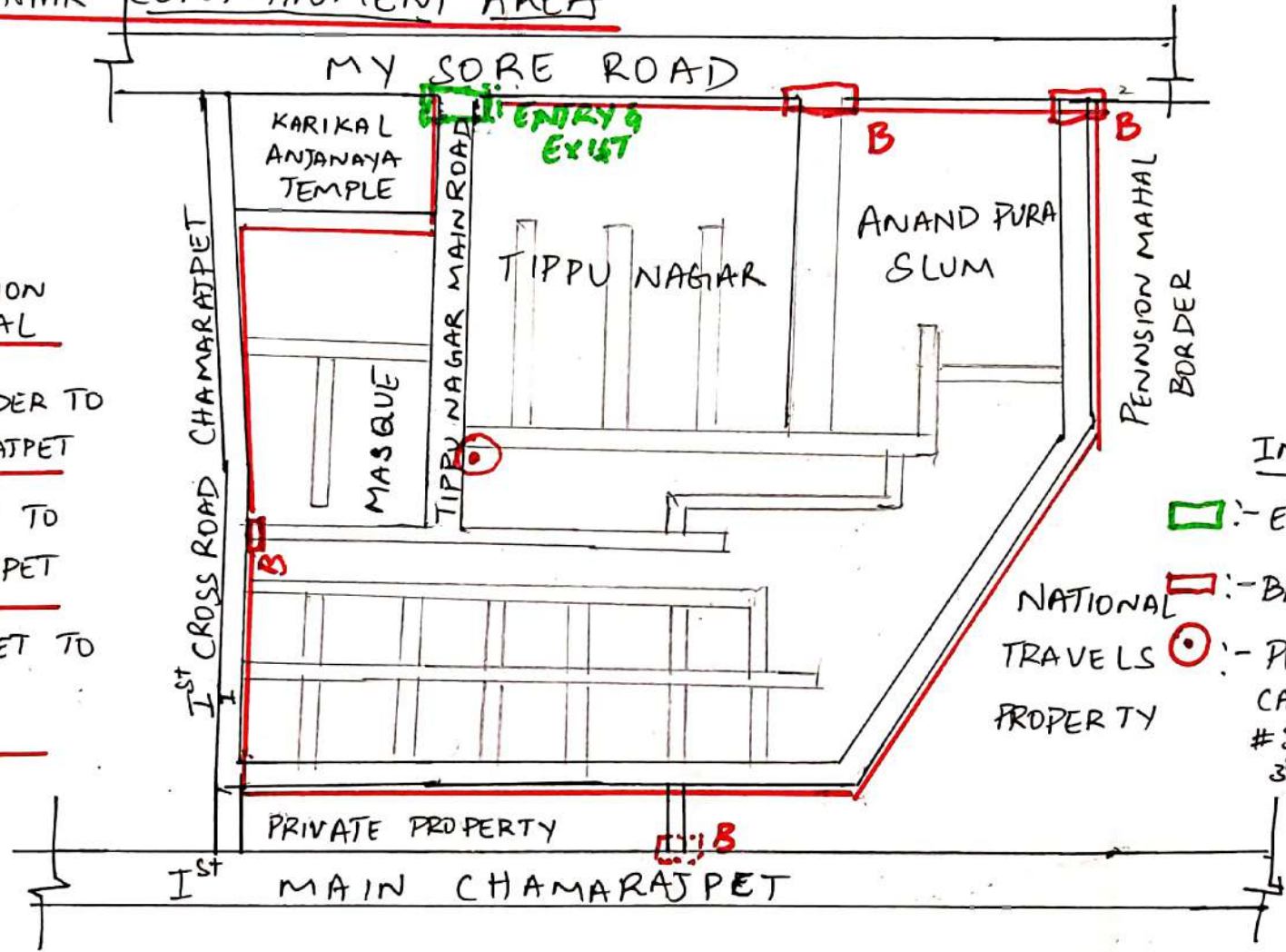

INDEX:-

- :- ENTRY & EXIT
- :- BARRICATED NATIONAL TRAVELS
- :- POSITIVE CASE PART # 356, 1ST MAIN 3RD CROSS TIPPUNAGAR

16.4.20

Umesh
 AEE (Chamarajpet)

WARD-135 PADRAYANAPURA

ALIST

P 167 TS,	198	200	316	291	350	352
168 TS	199	201	317	292	351	353
181	247					

RAILWAY LINE

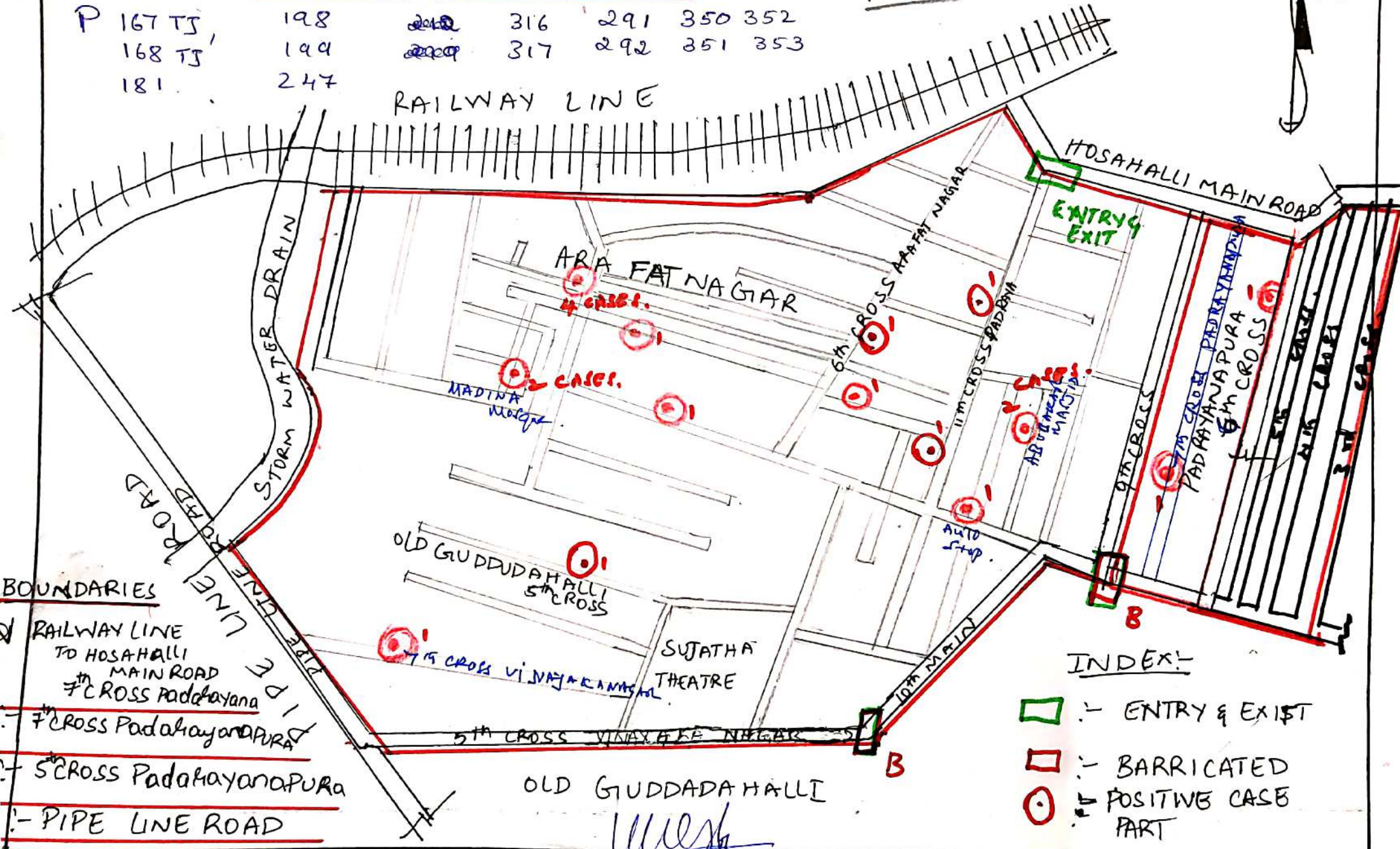

ENTRY
EXIT

ARA FAT NAGAR

4th CROSS

2nd CROSS

MADINA NAGAR

6th CROSS ARA FAT NAGAR

11th CROSS PADRAYANA

AR VIT NEKATU MADINA

9th CROSS

PADRAYANAPURA

5th CROSS

3rd CROSS

OLD GUDDADAHALLI
5th CROSS

SUJATHA
THEATRE

7th CROSS VINAYAKANAGAR

5th CROSS VINAYAK NAGAR

OLD GUDDADAHALLI

10th MAIN

INDEX:-

- :- ENTRY & EXIT
- :- BARRICATED
- 1 :- POSITIVE CASE PART

BOUNDARIES

- RAILWAY LINE TO HOSAHALLI MAIN ROAD
- 7th CROSS Padarayana
- 7th CROSS Padarayana
- 5th CROSS Padarayana
- PIPE LINE ROAD

AAE (JJR NAGAR)

CONTAINMENT ZONE MAP, WARD NO-160 R. R. NAGAR.

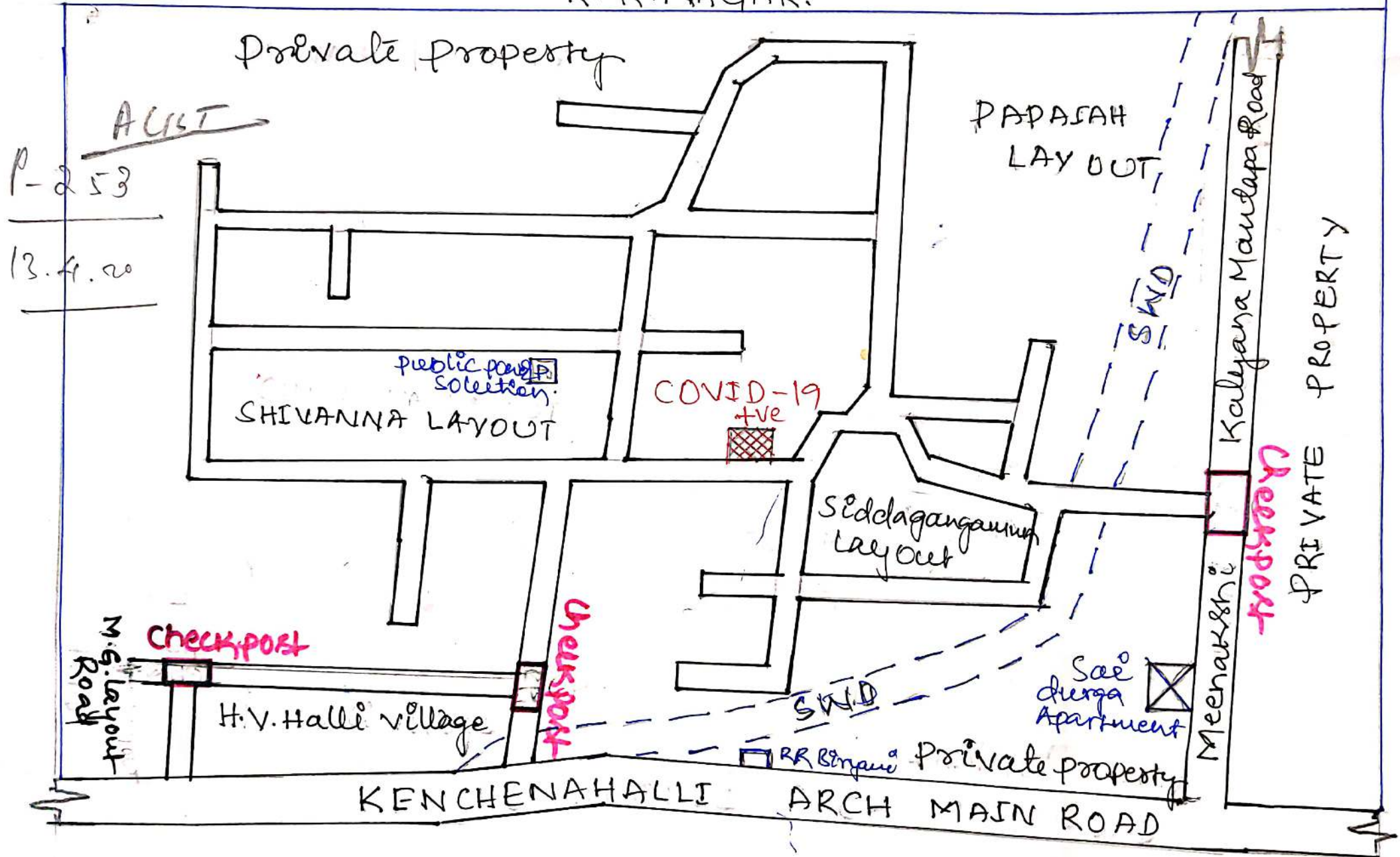
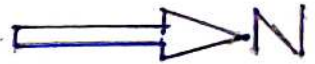

WEST

P. 93

GURAPPA HOUSE

W-54

6

MOTHER TERESA SCHOOL.

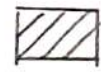

#33, 4th cross.

MOTAPPA KEMPANNA LAYOUT.

4th cross road.

G.T. ROAD.

RADDIY HOUSE

SOUTH

VARANASI MAIN ROAD.

BAKARAY CHORÉ.

NORTH



MAIN ROAD.

EAST

EE (M.D Pura)

[Signature]
ಕಂದಾಯ ಅಧಿಕಾರಿ

ಒಹಕ್ ಬೆಂಗಳೂರು ಮಹಾನಗರ ಪಾಲಿಕೆ
ಮುಹದೇವಪುರ ಕಲಾಂ, ಬೆಂಗಳೂರು.

WARD NO: 25 . HIRAMANU

APARTMENT NAME: MANTRI SPLENDOR APARTMENT GEDDALAHALLI

P-101

P-131



7

PID NO: 025-W0480-14

NO OF UNITS: 242



INDEX

-  CASE NUMBER: 101
131
 -  ENTRY AND EXIT
 -  BUS STAND
- POSITIVE CASE FLAT NO.
C-602 MANTRI SPLENDOR
R. APARTMENT. GEDDALAHALLI

R. Basavale
ಕಂಪೌಂಡ್ ಅಧಿಕಾರಿ
ಕೆ. ಆರ್. ಕ್ವರ್ಟರ್
ಬಿ.ಬಿ.ಎ. ಪಾರ್ಕ್, ಕಂಪೌಂಡ್-35

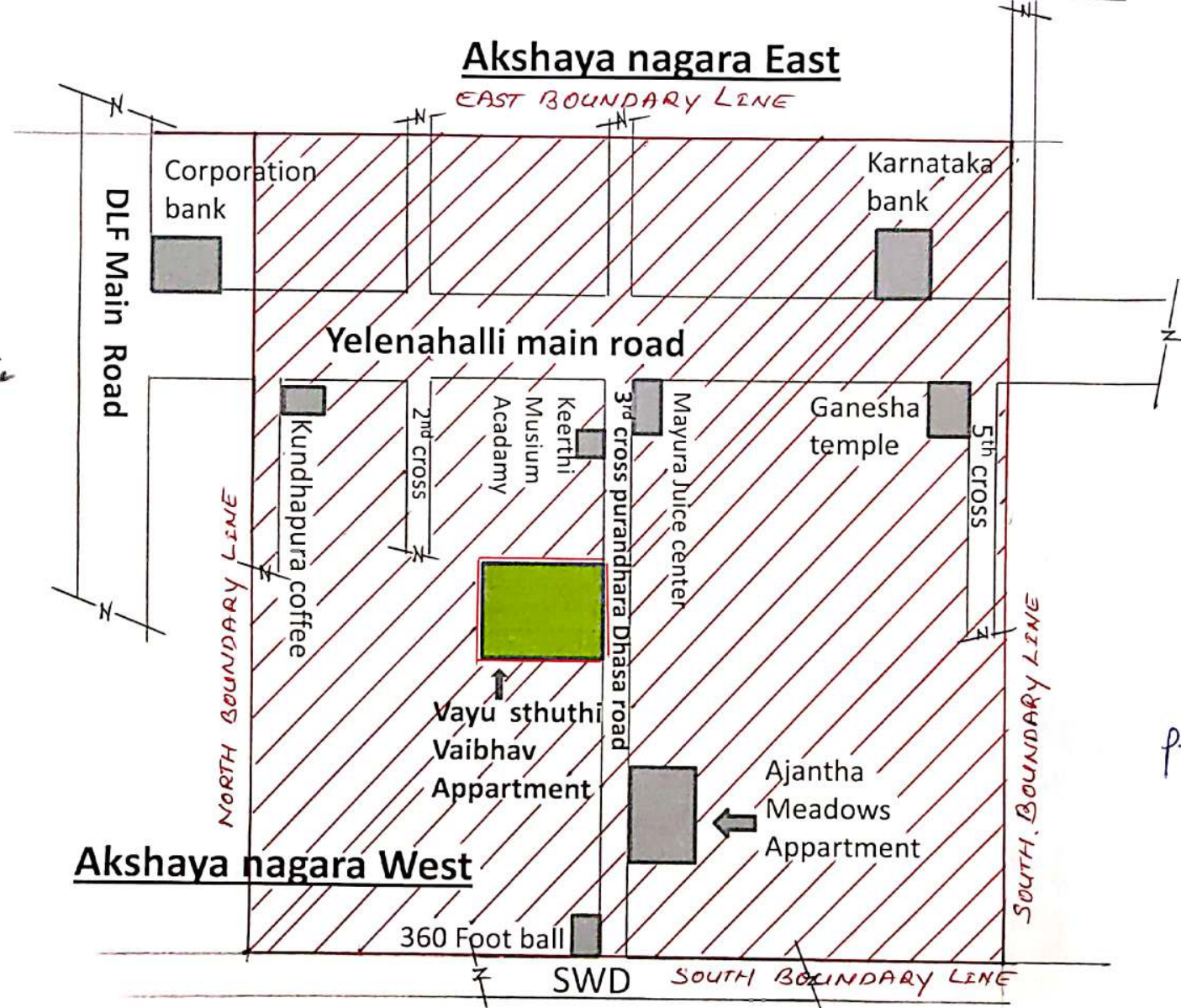

**BRUHAT BENGALURU MAHANAGARA PALIKE ,BOMMANAHALLI ZONE ,WARD NO 192 BEGUR,
 SKETCH SHOWS THE COVID 19 POSITIVE CASE PATIENT APPARTMENT BUILDING FLAT NO 203 3rd CROSS
 (PURANDHARA DASA ROAD) AKSHAYA NAGARA WEST**

P-170
 Do.
 6.4.20
 To be checked in
 New room data base



N ←

INDEX

-  Appartment building of the covid 19 positive patient (Vayu Sthuthi Vaibhav Appartment)
-  100.00 mt. BOUNDARY LIMIT-

f. k...
 Assistant Executive Engineer
 Begur Sub Division
 Bruhath Bengaluru Mahanagara Palike